

SHOWPRO

Que Par

SHWPAR111

RGBW - IP20

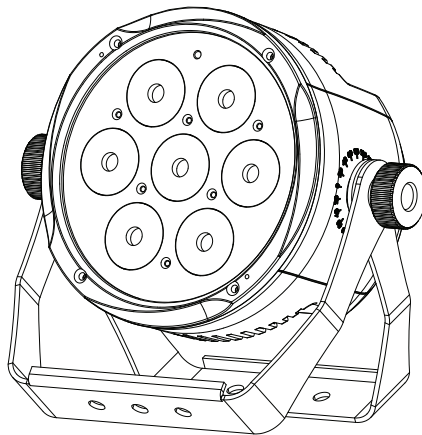

User Manual

Packaging: Thank you for purchasing the Que Par. Before operating, please check the fixture to ensure that no damage has occurred during transit. If damage is found, or the light operates abnormally, please contact the distributor for further instructions.

Overview: The Que Par has four operating modes:

The Que Par has four operating modes:

- DMX Mode
- Auto Mode
- Master/Slave Mode
- Sound Mode

There are four DMX modes: 5,7,10&15 channel

In addition if you daisy chain fixtures together in DMX mode and set one in Auto Mode and the others in Master/Slave Mode, the fixtures in Master/Slave Mode will follow the fixture in Auto Mode

SAFETY AND HANDLING

Before you operate this unit read the manual carefully. Always make sure to include the manual if you pass/rent/sell the unit to another user. Keep in mind that this manual cannot address all possible dangers and environments. Please use your own caution when operating. This product is for professional use only. It is not for household use.



- Do not operate this unit in areas with high ambient temperatures. It will cause abnormal function or damage.
- Always use a suitable safety wire when rigging the light overhead.
- Connect the safety wire to the intended safety mount.
- Always follow local safety requirements.



- Only qualified technicians may repair this product.
- Do not open the product housing.
- Do not supply power if the fixture is damaged.



- Do not look directly into the light source.
- Looking into the light source can cause damage to your eyes.
- Do not look at the light source with a magnifying glass or any other optical instrument that may concentrate the light output.



- The housing of the fixture can become hot. It can reach up to 70°C during normal operation.
- Ensure that accidental physical contact cannot occur with the fixture.
- Only install in well ventilated locations.
- Do not cover the fixture.



- At end of life, dispose the unit responsibly in accordance to local regulations or procedures.
- The packaging is recyclable.

Troubleshooting

The fixture and display turns on, but the LED engine does not emit.

The fixture could be set to BLACKOUT mode or set to DMX Hold and isn't receiving a valid signal. Verify if receiving DMX. Perform a Factory Reset.

The fixture is not working correctly- it does not output the colour or effect it should be.

Check that the DMX address and mode is set correctly. Ensure that the fixture is receiving DMX. Otherwise perform a Factory Reset.

The fixture still cannot be controlled, or not as expected after Factory Reset.

Run DMX directly to the fixture, not part of a daisy chain. Power cycle the fixture by removing the power. If the issue still occurs, contact distributor.

Features

OPTICS

- Light Source: 7 x 15W RGBW LED
- Beam Angle: 25°
- DMX Channel: 5, 7, 10 & 15 CH

ELECTRICAL

- Power consumption: 70W
- Voltage: AC 110 - 240V,
50/60Hz

CONTROL

- Operation Mode: DMX 512, Manual, sound, internal program
- Control panel: Digital 4 characters alphanumeric

EFFECT

- Dimming 0-100%with regulated constant color control
- Strobe: 10 flash per second

PHYSICAL

- Material: Aluminum body
- TFT Display with four buttons
- Dimensions: 258 x 190 x 208mm
- Weight: 2.5kg
- IP Rating: IP20

Accessory

- ① Power cable x 1
- ② User manual x 1
- ③ IR Remote x 1

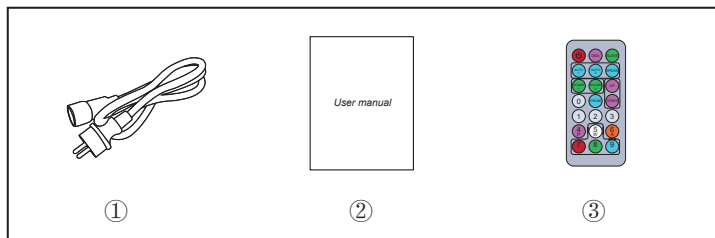

Menu Structure

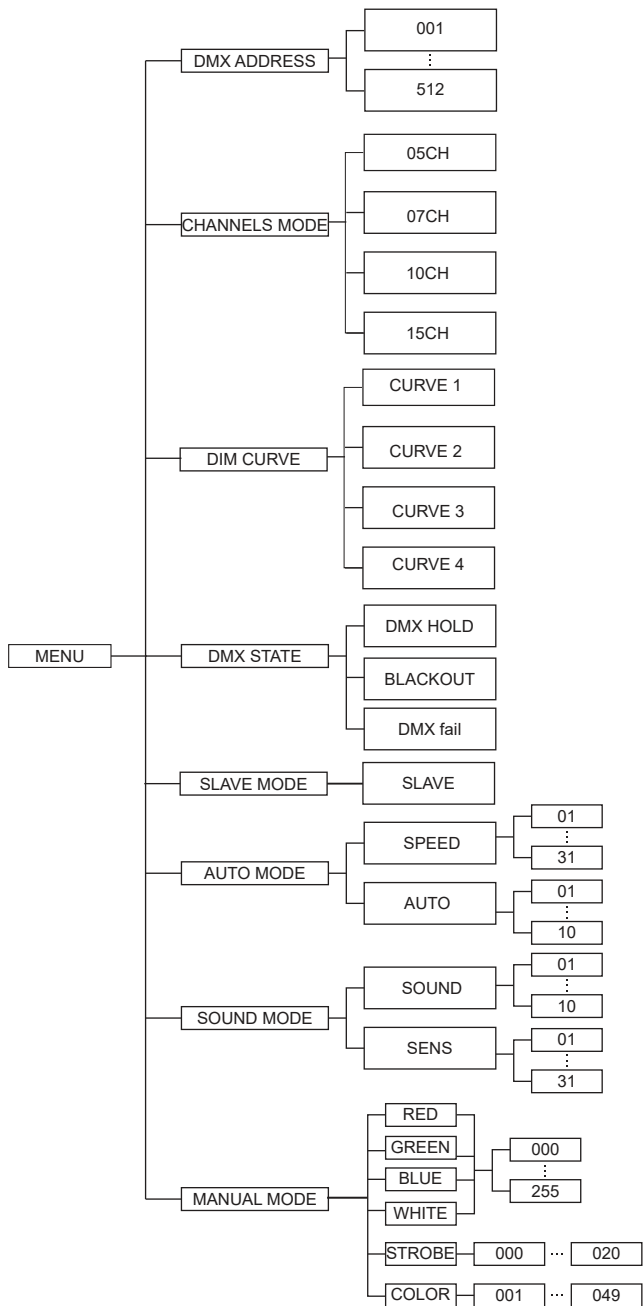

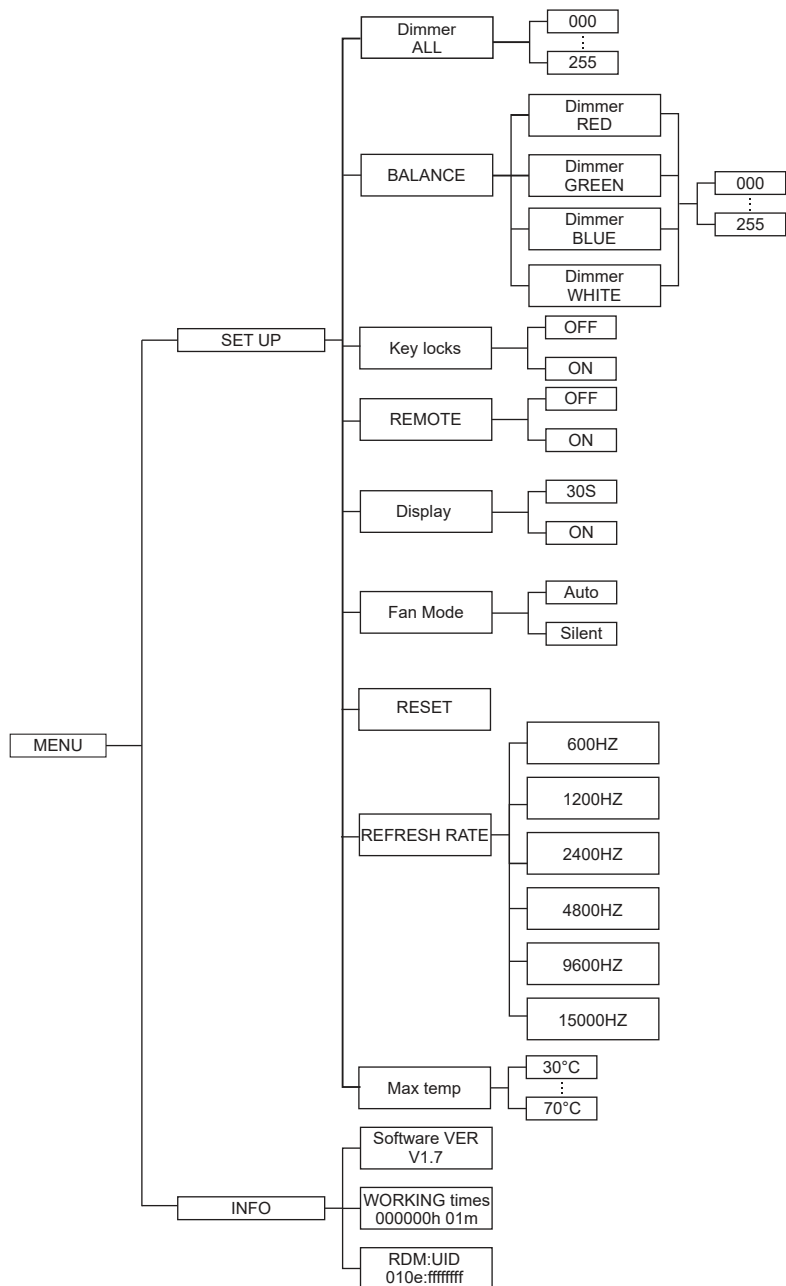

Display Introduction

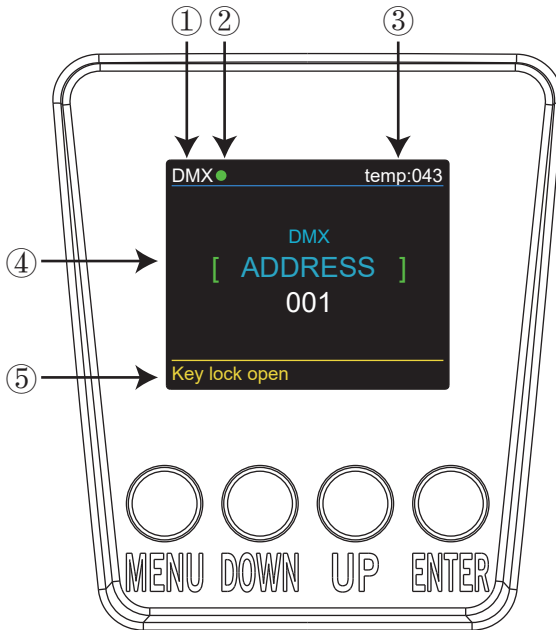

1. Indicates if you are in DMX mode or in SLAVE mode. Will display either DMX or SLAVE.
2. Displays the condition of signal being transmitted. Green is connected. Red is disconnected.
3. The temperature of the fixture.
4. The current menu selection.
5. Status of the key lock.

DMX Address: In this mode you control the lights with an external controller outputting DMX512 protocol.

Press ENTER button and use the UP or DOWN buttons until "DMX ADDRESS " is displayed. Press the ENTER button, "xxx" will appear. "x" represents the current address set. Use UP or DOWN to set the desired address (001-512).

Channel Mode: Press ENTER and use UP or DOWN buttons until "CHANNEL MODE " is displayed. Press ENTER,

"Channel [xx]" will appear. "x" represents the current DMX channel mode. Use the UP or DOWN buttons to select your desired Channel mode (05,07,10,15)

DIM CURVE - In this menu, you can select a desired dimmer curve (curve1-curve4).

1. Press "ENTER" button and then UP or DOWN button until "DIM CURVE" is shown.
2. Press "ENTER" button, and use the UP or Down buttons to select a curve. Press ENTER to confirm.

DMX STATE -In this menu, you can adjust the DMX state (DMX HOLD, BLACK OUT or DMX FAIL

1. Press "ENTER" button and then UP or DOWN button until "DMX STATE" is shown.
2. Press "ENTER" button, and there will be the following options to choose from:
(1) DMX HOLD – You can keep the DMX mode;
(2) BLACKOUT - Blackouts DMX mode to have another mode active.
(3)DMX FAIL-If DMX is not connected, DMX Fail will be displayed.

SLAVE MODE - In this menu, you can select one light as the MASTER light and others to be in SLAVE mode. Fixtures in SLAVE mode will follow the MASTER light.

1. Press "ENTER" button and then UP or DOWN button until "SLAVE MODE" is shown.
- 2.Press "ENTER" button to confirm..

AUTO MODE- In this menu, you can select an AUTO mode (1-15) and adjust the running speed (1-31).

1. Press ENTER and use UP or DOWN until "AUTO" is displayed.
2. Press ENTER, and "SPEED" or "AUTO MODE" will appear. Press ENTER to select and adjust either:
(1) SPEED - Select the desired speed.
(2) AUTO - Select the desired auto mode.

SOUND MODE - In this menu, you can select your desired sound mode(1-10) and adjust the sensitivity(1-31).

1. Press the MENU button and UP button or DOWN button until "SOUND" appears, then press ENTER.
(1) SOUND - You can select the sound mode in this menu.
(2) SENS - You can adjust the sensitivity in this menu.

MANUAL MODE–In this menu, you can adjust RGBW(0-255), COLOUR(1-49), and STROBE(0-20).

1. Press the ENTER button and use UP or DOWN until "MANUAL" is displayed.
2. Press ENTER. There are six options to select from. Use the UP or DOWN buttons and press

ENTER to select and confirm the desired option and value.

- (1)RED - Manually set the red intensity.
- (2)GREEN - Manually set the green intensity.
- (3)BLUE - Manually set the blue intensity.
- (4)WHITE- Manually set the white intensity.
- (5)STROBE - Set and adjust the strobe speed (0-20)
- (6)COLOUR - Sets the fixture to one of the 49 pre-programmed colours.

SET UP-In this menu, you can adjust the value of a function.

- 1. Press the ENTER button and use the UP or DOWN buttons until "SET UP" is displayed.
- 2. Press ENTER. There will be 9 options. Press ENTER to select an option and use UP or DOWN to change values.

- (1) DIMMER ALL - Adjusts the brightness over all colours.
- (2) BALANCE -Adjusts the brightness of each color (R,G,B,W) from 000-255 .
- (3) KEY LOCK- Choose whether the menu password is active.

By default the password is UP + DOWN + UP + DOWN .If "ON", the user has to input the password before entering the menu. The light cannot be altered until the correct password is entered.

- (4) REMOTE - Allows for remote control to be enabled or disabled.
- (5) DISPLAY - Select between "ON" or "30S". If "ON" is selected, the display will constantly output. If "30S" is selected, the display will turn off after 30 seconds of no user input.
- (6) FAN MODE- Set the fixture to a particular fan mode (AUTO or SILENT)

- 1)Press "ENTER" button and then UP or DOWN button until "FAN" is displayed.
- 2)Press "ENTER" button, and there will be 2 options. Then, press ENTER to choose your desired fan mode.

- (7) RESET-Resets all values set to default. The password is [UP] + [DOWN] + [UP] + [DOWN].

- (8) REFRESH RATE – Able to set the refresh rate of the fixture.(600Hz,1200Hz,2400Hz,4800Hz,9600Hz,15000Hz).

- (9) MAX TEMP - A custom Max working temperature can be set for the fixture. When the temperature exceeds the value set, the text colour of "Temp xx" in the main display will change from white to yellow. Meanwhile, the fixture will adjust the working temperature automatically.

INFORMATION- Provides information of the software version, hardware, RDM UID and the working time of the fixture.

- 1. Press ENTER button and use UP or DOWN until "INFO" is displayed.
- 2. Press ENTER. Use UP or DOWN to navigate and then ENTER to view:

- (1) SOFTWARE- The running Software version.
- (2) WORKING TIME- Total operating hours since manufacture.

Note:the working time that will be saved if the time more than one hour.

- (3) RDM UID- Displays the RDM UID information.

DMX Chart

DMX 5 channel

channel	value	function
1	0 - 255	Red
2	0 - 255	Green
3	0 - 255	Blue
4	0 - 255	White
5	0 - 255	Dimmer speed

DMX 7 channel

channel	value	function
1	0 - 255	Dimmer
2	0 - 255	Red
3	0 - 255	Green
4	0 - 255	Blue
5	0 - 255	White
6		strobe
	000 - 009	led on
	010 - 255	strobe1(slow to fast)
7	0 - 255	Dimmer speed

DMX 10 channel

channel	value	function
1	0 - 255	Dimmer
2	0 - 255	Red
3	0 - 255	Green
4	0 - 255	Blue
5	0 - 255	White
6	000-009	led on
	010-255	strobe(slow to fast)
7	000-009	No Function
	010-174	Static Color
	175-189	3200k
	190-204	5600k
	205-219	6500k
	220-234	8500k
	235-249	10000k
	250-255	Default
8	000-020	No Function
	021-030	Auto 1
	031-040	Auto 2
	041-050	Auto 3

channel	value	function
8	051 - 060	Auto 4
	061 - 070	Auto 5
	071 - 080	Auto 6
	081 - 090	Auto 7
	091 - 100	Auto 8
	101 - 110	Auto 9
	111 - 120	Auto 10
	121 - 255	reserved
9	0 - 255	Speed slow to fast
10	0 - 255	Dimmer speed

DMX 15 channel

channel	value	function
1	0 - 255	Dimmer
2	0 - 255	Dimmer fine
3	0 - 255	Red
4	0 - 255	Red fine
5	0 - 255	Green
6	0 - 255	Green fine
7	0 - 255	Blue
8	0 - 255	Blue fine
9	0 - 255	White
10	0 - 255	White fine
11		strobe
	000-009	led on
	010-255	strobe(slow to fast)
12	000-009	No Function
	010-174	Static Color
	175-189	3200k
	190-204	5600k
	205-219	6500k
	220-234	8500k
	235-249	10000k
	250-255	Default
13	000-020	No Function
	021-030	Auto 1
	031-040	Auto 2
	041-050	Auto 3
	051-060	Auto 4
	061-070	Auto 5
	071-080	Auto 6

channel	value	function
13	081 - 090	Auto 7
	091 - 100	Auto 8
	101 - 110	Auto 9
	111 - 120	Auto 10
	121 - 255	reserved
14	0 - 255	Speed slow to fast
15	0 - 255	Dimmer speed

Dimmer speed		
0	49	Dimmer Speed 0
50	99	Dimmer Speed 1
100	149	Dimmer Speed 2
150	199	Dimmer Speed 3
200	255	Dimmer Speed 4

Mounting

When installing the unit, the trussing or area of installation must be able to hold 10 times the weight without any deformation. When installing the unit, secure it with an appropriately rated safety chain. Ensure the area beneath the fixture is clear when mounting, removing or servicing the unit.

Overhead mounting requires extensive experience, including calculating working load limits, installation material being used, and periodic safety inspection of all installation material and the unit. If you lack these qualifications, do not attempt the installation yourself. The installation should be checked by a skilled technician once a year.

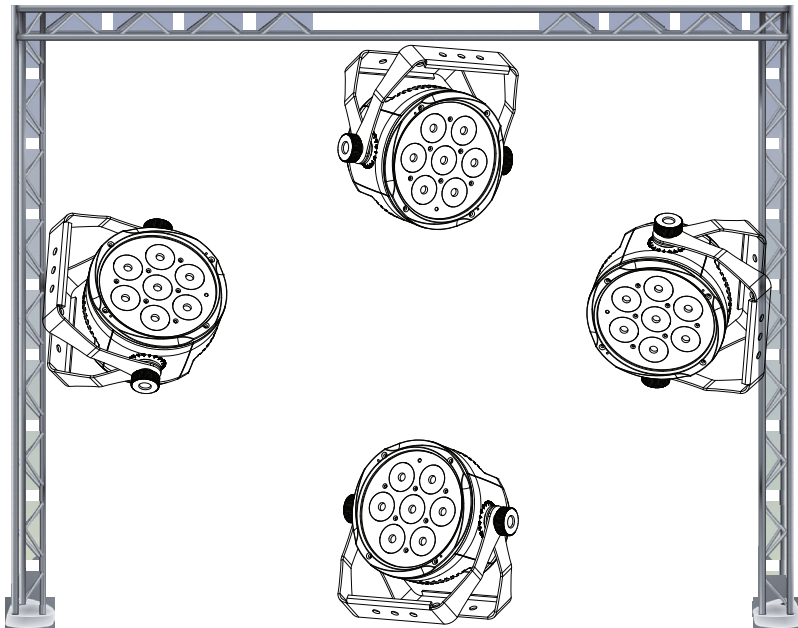

The Que Par is fully operational in three different mounting positions: hanging upside-down from a ceiling, set on a flat level surface or mounted on its side. Be sure to keep the fixture at least 0.5m away from any flammable materials (decorations etc.).

Use an appropriately rated safety chain to prevent accidental damage or injury to persons in the event the clamp fails.
the clamp fails (see next page).

Product Overview

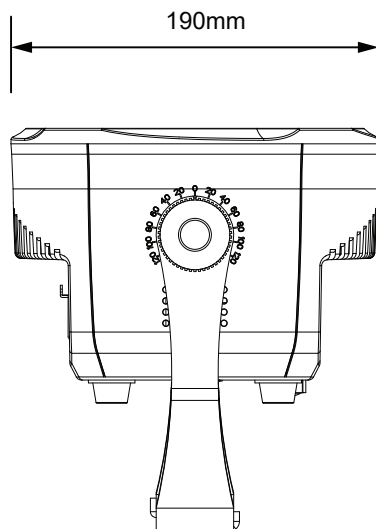
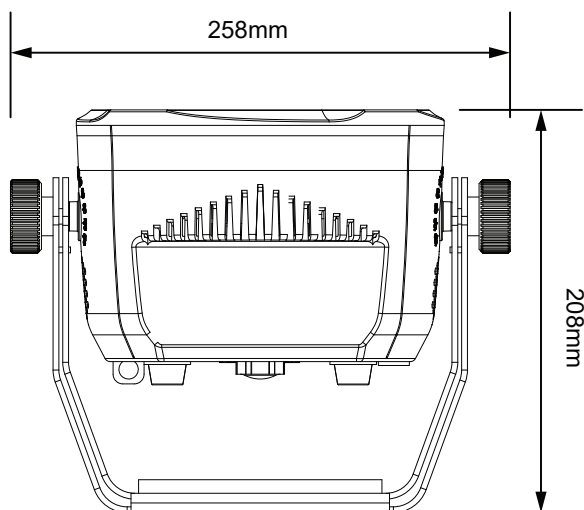

RDM

RDM compliance:ANSI/ESTA E.120

Parameter ID	Command 'Discovery'	Command 'Set'	Command 'Get'
DISC_UNIQUE_BRANCH	√		
DISC_MUTE	√		
DISC_UN_MUTE	√		
DEVICE_INFO			√
SUPPORTED_PARAMETERS			√
SOFTWARE_VERSION_LABEL			√
DMX_START_ADDRESS		√	√
IDENTIFY_DEVICE		√	√
DEVICE_MODEL_DESCRIPTION			√
PARAMETER_DESCRIPTION			√
MANUFACTURER_LABEL			√
DEVICE_LABEL		√	√
FACTORY_DEFAULTS		√	√
BOOT_SOFTWARE_VERSION_ID			√
BOOT_SOFTWARE_VERSION_LABEL			√
DMX_PERSONALITY		√	√
DMX_PERSONALITY_DESCRIPTION			√
SLOT_INFO			√
SLOT_DESCRIPTION			√
SENSOR_DEFINITION			√
SENSOR_VALUE			√
DEVICE_HOURS			√
LAMP_HOURS			√
RESET_DEVICE		√	
CURVE		√	√
DMX STATE		√	√
DIMMER SPEED		√	√

IR Controller

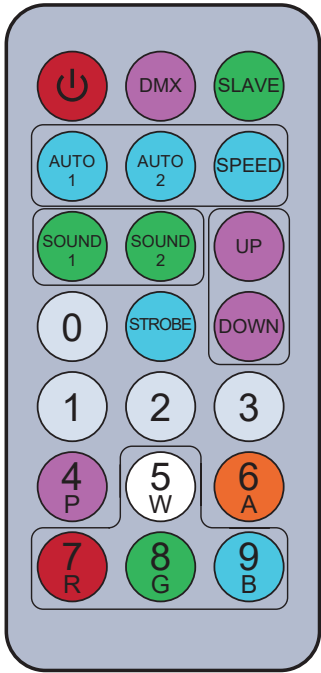

Power on/off button



DMX Button- Controls DMX address with single press, double press controls DMX mode.



Master-slave mode button.



Automatic mode button



Speed adjust button



Sound mode button



Up & Down button allows you to choose programs or adjusts numerical values.



Strobe button



Able to insert numerical values in any program mode.



Selects a particular colour.